

## Function Rooms, on Level II and Ground Floor

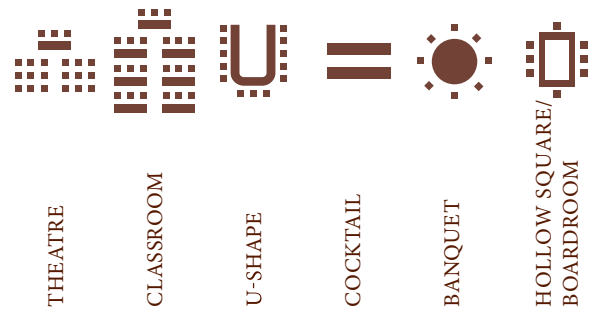
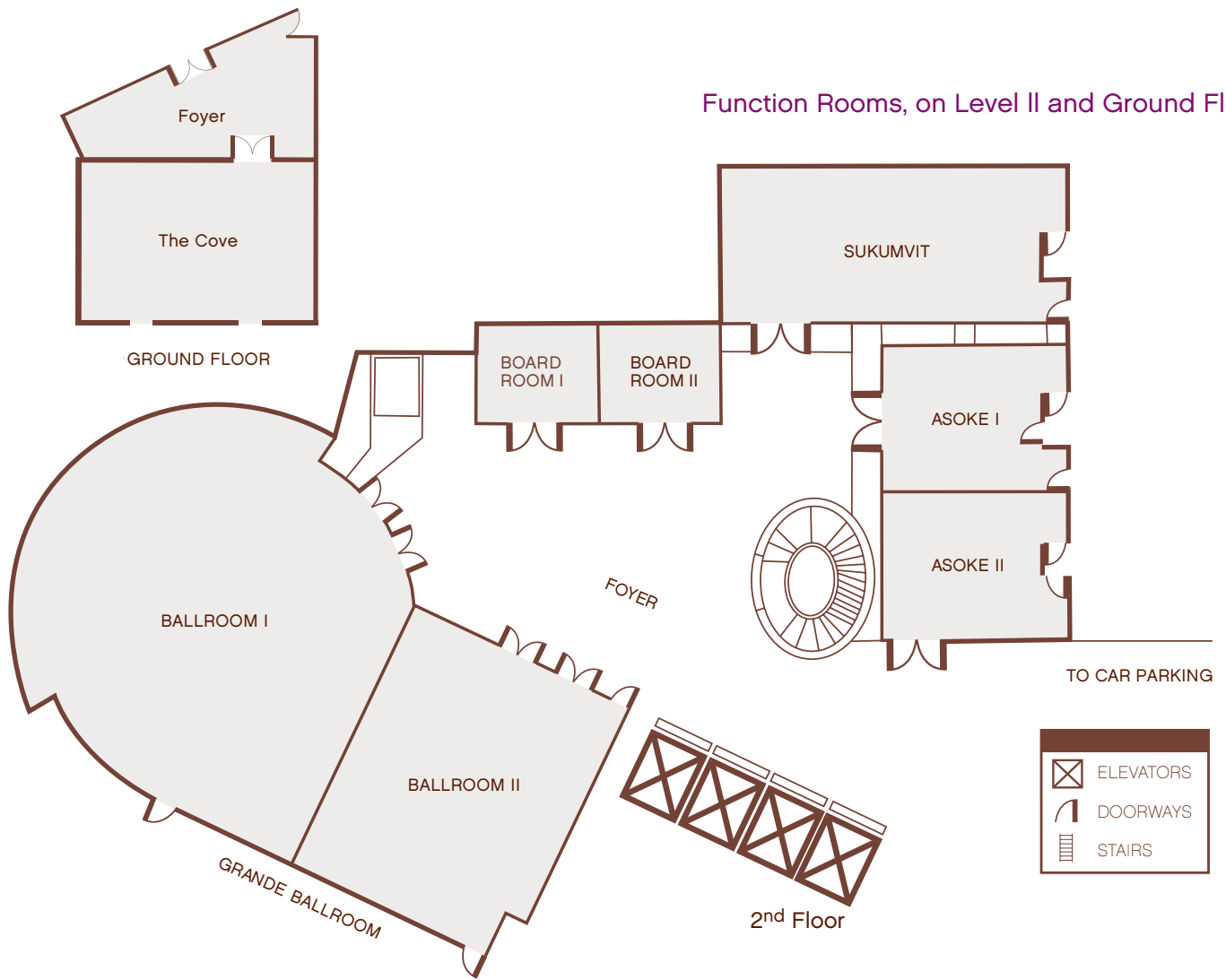

	AREA (m <sup>2</sup> )	SIZE (m x m)	CEILING HEIGHT (m)	THEATRE	CLASSROOM	U-SHAPE	COCKTAIL	BANQUET	HOLLOW SQUARE/ BOARDROOM
GRANDE BALLROOM	444	28 X 14.4*	8 - 9	500	300	87	500	380	102
BALLROOM I	300	18 X 14.4*	9	260	150	50	320	250	66
BALLROOM II	144	10 X 14.4	8	120	72	33	130	80	42
SUKHUMVIT	136	17 X 8	4.75	120	72	39	130	80	48
GRANDE ASOKE	167	19.6 X 8.5	4.75	100	54	-	130	100	-
ASOKE I	85	10 X 8.5	4.75	50	33	24	50	50	30
ASOKE II	82	9.6 X 8.5	4.75	50	33	24	50	50	30
BOARDROOM I	25	5.5 X 4.5	4.75	-	-	-	-	-	12
BOARDROOM II	24	5.5 X 4.4	4.75	-	-	-	-	-	12
THE COVE	79	10.8 X 7.3	3.1	50	33	24	70	50	30

• \*Plus 40 m<sup>2</sup>

• 240 parking spaces and valet service is provided

• With a direct link from the hotel's lobby to the Asok SkyTrain station and a few steps to Sukhumvit subway station.